

青口投资区林森大道（二期）道路工程（青口段）红线图  
2866.3-40436.7

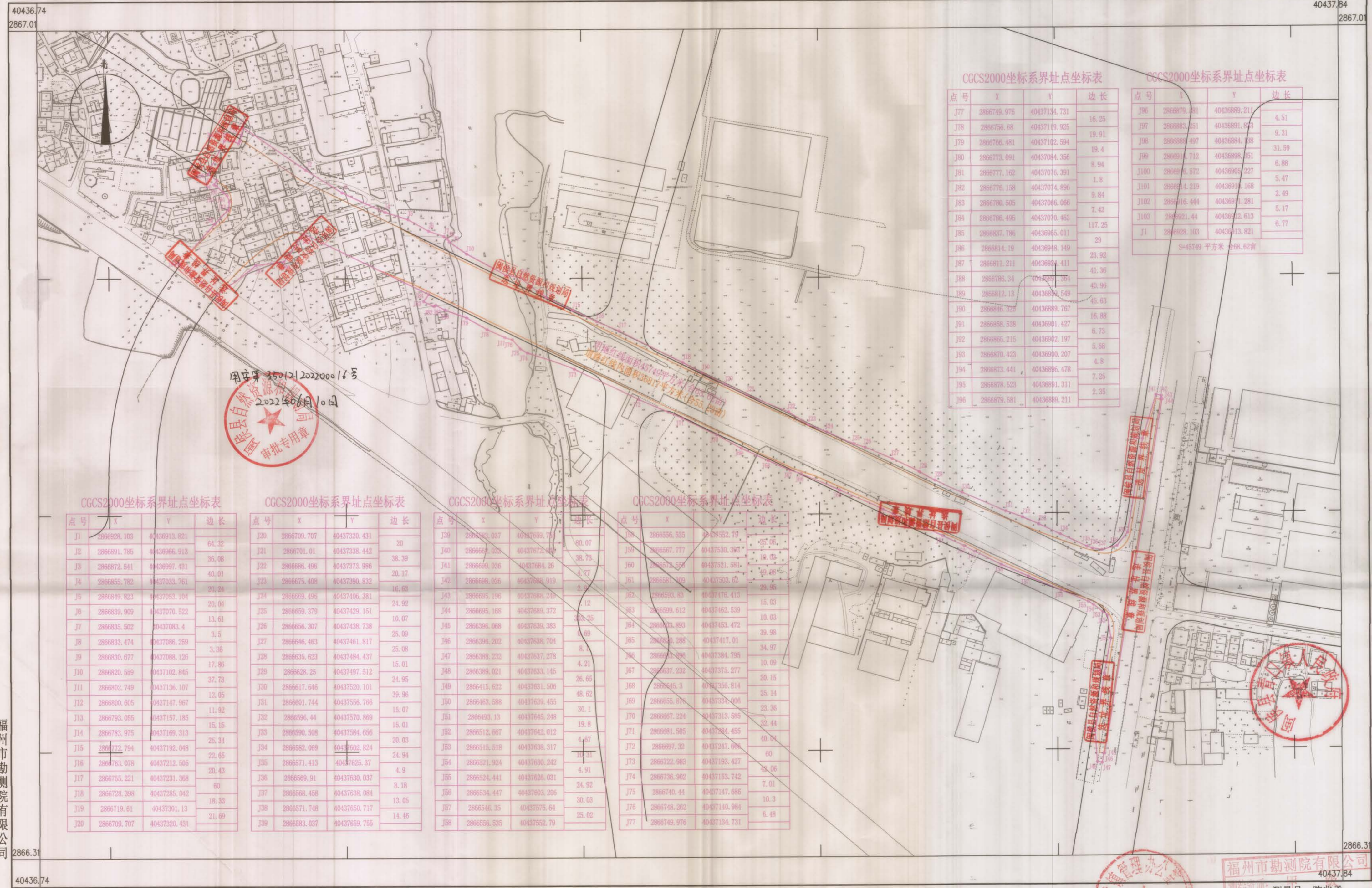

CGCS2000坐标系界址点坐标表

点号	X	Y	边长
J77	2866749.976	40437134.721	16.25
J78	2866736.68	40437118.925	19.91
J79	2866766.481	40437192.594	19.4
J80	2866773.091	40437084.356	8.94
J81	2866777.162	40437076.391	1.8
J82	2866776.158	40437074.896	9.84
J83	2866780.505	40437066.066	7.42
J84	2866786.495	40437070.462	117.25
J85	2866837.786	40436965.011	29
J86	2866814.19	40436948.149	23.92
J87	2866811.211	40436824.411	41.36
J88	2866786.34	40436811.304	40.96
J89	2866812.13	40436829.549	45.63
J90	2866826.325	40436889.767	16.88
J91	2866858.528	40436961.427	6.73
J92	2866865.215	40436802.197	8.58
J93	2866870.423	40436900.207	4.8
J94	2866873.441	40436896.478	7.25
J95	2866878.529	40436891.311	2.35
J96	2866879.581	40436889.211	

CGCS2000坐标系界址点坐标表

点号	X	Y	边长
J96	2866879.581	40436889.211	4.51
J97	2866883.251	40436891.823	9.31
J98	2866889.497	40436884.28	31.59
J99	2866914.712	40436898.251	6.88
J100	2866916.572	40436903.227	5.47
J101	2866914.219	40436914.168	2.49
J102	2866916.444	40436911.281	5.17
J103	2866921.44	40436912.613	6.77
J1	2866928.103	40436913.821	

S=45749 平方米 2198.62亩

CGCS2000坐标系界址点坐标表

点号	X	Y	边长
J1	2866928.103	40436913.821	64.32
J2	2866891.785	40436966.913	36.08
J3	2866872.541	40436997.431	40.01
J4	2866855.782	40437033.761	20.24
J5	2866849.923	40437053.194	20.04
J6	2866839.909	40437070.522	13.61
J7	2866835.502	40437083.4	3.5
J8	2866833.474	40437096.259	3.36
J9	2866830.677	40437088.126	17.86
J10	2866820.599	40437102.845	37.73
J11	2866802.749	40437136.107	12.05
J12	2866800.605	40437147.967	11.92
J13	2866793.056	40437157.185	15.15
J14	2866783.975	40437169.313	25.34
J15	2866772.794	40437192.048	22.65
J16	2866763.078	40437212.506	20.43
J17	2866755.221	40437231.368	60
J18	2866728.398	40437285.042	18.33
J19	2866719.81	40437301.13	21.69
J20	2866709.707	40437320.431	

CGCS2000坐标系界址点坐标表

点号	X	Y	边长
J20	2866709.707	40437320.431	20
J21	2866701.01	40437338.442	38.39
J22	2866686.496	40437373.986	20.17
J23	2866675.408	40437390.832	16.63
J24	2866669.496	40437406.381	24.92
J25	2866659.379	40437429.151	10.07
J26	2866636.307	40437438.738	25.09
J27	2866646.463	40437461.817	25.09
J28	2866635.623	40437484.437	15.01
J29	2866628.25	40437497.512	24.95
J30	2866617.646	40437520.101	39.96
J31	2866601.744	40437556.706	15.07
J32	2866596.44	40437570.869	15.01
J33	2866590.508	40437584.656	20.03
J34	2866582.669	40437602.824	24.94
J35	2866571.413	40437625.37	4.9
J36	2866569.91	40437630.037	8.18
J37	2866568.458	40437638.094	13.05
J38	2866571.748	40437650.717	14.46
J39	2866563.037	40437659.755	

CGCS2000坐标系界址点坐标表

点号	X	Y	边长
J39	2866563.037	40437659.755	80.07
J40	2866669.023	40437672.817	38.73
J41	2866659.036	40437684.26	4.77
J42	2866668.026	40437688.919	2
J43	2866669.196	40437688.247	12
J44	2866665.185	40437689.372	300.26
J45	2866636.068	40437639.383	6.6
J46	28666396.202	40437638.704	8
J47	2866638.232	40437637.278	4.21
J48	28666389.021	40437633.145	26.65
J49	28666415.622	40437631.506	48.62
J50	28666463.888	40437630.455	30.1
J51	28666496.13	40437645.248	19.8
J52	2866612.667	40437642.012	4.67
J53	2866615.518	40437638.317	11.31
J54	2866621.924	40437630.242	4.91
J55	2866624.441	40437626.031	24.92
J56	2866634.447	40437603.206	30.03
J57	2866646.35	40437575.64	25.02
J58	2866656.535	40437552.79	

CGCS2000坐标系界址点坐标表

点号	X	Y	边长
J58	2866656.535	40437552.79	25.02
J59	2866667.777	40437530.393	18.03
J60	2866675.556	40437521.581	19.49
J61	2866681.309	40437503.62	29.96
J62	2866693.83	40437476.413	15.03
J63	2866699.612	40437462.539	10.03
J64	2866703.893	40437453.472	39.98
J65	2866703.288	40437417.01	34.97
J66	2866703.286	40437394.796	10.09
J67	2866707.232	40437375.277	30.15
J68	2866705.3	40437356.814	25.14
J69	2866705.876	40437339.096	23.36
J70	2866707.224	40437313.598	32.44
J71	28667081.505	40437291.455	40.04
J72	2866707.32	40437247.608	60
J73	2866722.983	40437193.427	48.06
J74	2866736.902	40437153.742	7.01
J75	2866740.44	40437147.686	10.3
J76	2866748.282	40437140.994	8.48
J77	2866749.976	40437134.721	

福州市勘测院有限公司

2018年8月全野外数字化采集。  
CGCS2000坐标系，中央子午线120°。  
罗零高程系，等高距为1米。  
2017版图式。

1:2000

福州市勘测院有限公司  
测量员：陈兆勇  
绘图员：林配榕  
检查员：谢长富  
发证机关：福建省自然资源厅